

TECH-NEWS

Handle Bracket Update**October, 2010**

We have received a few complaints about the handle attachment to the mower deck:

- The handle tubes are "flexing" too much
- A few clamps and rear brackets have broken

To address these complaints we have redesigned the rear handle brackets per the illustration. The new design separates the tube clamps (201024-1) and contributes to an overall stronger attachment of the handle to the mower.

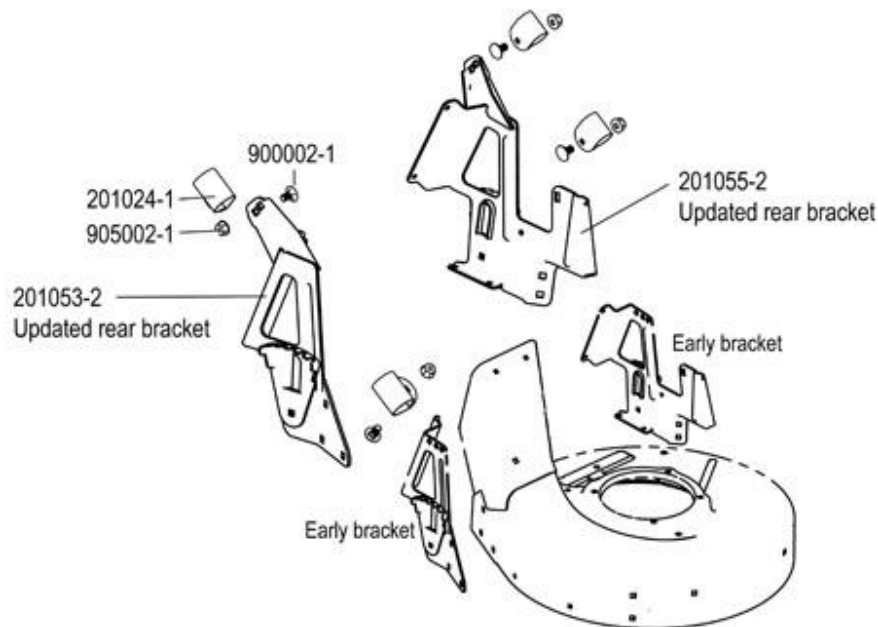

To simplify any updates for our customers we have a complete kit available at a subsidized price.

Kit Part #: [996001-1](#) Rear Bracket Update Kit. List price \$30.00

This kit includes:

- 4ea 201024-1 Handle Clamp
- 1ea 201053-2 Bracket, Right Rear Assembly
- 1ea 201055-2 Bracket, Left Rear Assembly
- 4ea 900002-1 Carriage Bolt, M8x16
- 4ea 905002-1 Flange Nut Locking-M8

All mower deliveries as of September 15, 2010 include the new brackets and handle attachments.

- One click to [Illustrated Parts Lists](#) (I.P.L.'s)
- One click to [Quick Order Form](#)
- One click to [Archived Tech-News](#)
- One click to [.pdf Version of This Page](#)
- One click to [Home Page](#)

For additional Information, please call 1.888.Ybravo.1 or [contact us](#).